

3. SPOJNI PRIBOR General hardware

3.5. Natezni vijci, zateznice

Green Pin zateznica G-6311

Green Pin® Turnbuckle G-6311

2.1 2.2 CE 3.1 MTCa 

Nosivost (t)	A (")	D (mm)	Max. duljina produljenja vilice (inch)	B (mm)	C (mm)	E (mm)	F (mm)	G (mm)	H (mm)	Težina (kg/kom)
WLL			take up							Weight
0.54	3/8	183	6	292	428	10	13	29	49	0.48
1	1/2	193	6	325	455	12	18	36	58	0.81
1	1/2	270	9	400	608	12	18	36	57	1.07
1	1/2	346	12	476	760	12	18	36	57	1.29
1.59	5/8	203	6	380	503	14	21	45	79	1.33
1.59	5/8	280	9	455	656	14	21	45	78	1.61
1.59	5/8	356	12	531	808	14	21	45	78	1.96
2.36	3/4	214	6	413	532	17	26	54	89	2.03
2.36	3/4	291	9	490	685	17	26	54	89	2.47
2.36	3/4	367	12	564	837	17	26	54	88	2.9
2.36	3/4	519	18	718	1,143	17	26	54	89	3.94
3.27	7/8	377	12	604	870	20	32	61	101	4.31
3.27	7/8	529	18	756	1,174	20	32	61	101	5.51
4.5	1	692	24	952	1,518	24	37	76	116	7.52
4.54	1	234	6	498	604	24	37	76	118	4.35
4.54	1	387	12	649	909	24	37	76	117	5.75
4.54	1	539	18	801	1,215	24	37	76	117	7.27
6.9	1 1/4	385	12	712	985	29	47	91	145	9.28
6.9	1 1/4	537	18	862	1,287	29	47	91	144	11.1
6.9	1 1/4	690	24	1,015	1,592	29	47	91	144	12.1
9.71	1 1/2	401	12	756	1,023	32	55	106	156	14.2
9.71	1 1/2	553	18	916	1,335	32	55	106	160	15.8
9.71	1 1/2	706	24	1,065	1,636	32	55	106	158	17.1
12.7	1 3/4	577	18	1,020	1,396	38	61	120	197	23.1
12.7	1 3/4	730	24	1,171	1,703	38	61	120	196	26.3
16.8	2	748	24	1,264	1,784	46	69	147	230	40.7
27.2	2 1/2	802	24	1,430	1,934	51	80	165	274	64
34	2 3/4	802	24	1,450	1,988	57	84	178	284	88

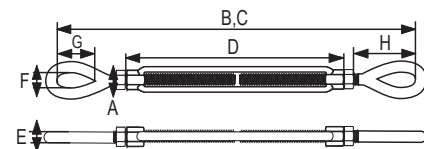

Natezni vijak hamburger RX-lift

Turnbuckle type "hamburger"

Prekidna sila (t)	Promjer navoja A (mm)	B (mm)	C (mm)	D (mm)	Težina (kg/kom)
BL	Dia. thread				Weight (kg/pc)
13	24	400	16	210	2,8
13	24	500	16	260	3,8
18	27	400	18	210	4,4
18	27	500	18	260	5,5
20	30	400	20	210	5
20	30	500	20	260	6,3
21	36	400	20	210	7
21	36	500	20	260	8,8

2.1 2.2

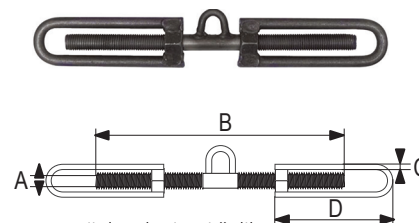

- materijal: nelegirani čelik
- završna obrada: crno