

3. SPOJNI PRIBOR General hardware

3.2. Karabineri, spojnice

Aluminijska klema DIN 3093 / EN 13411-3 RX-lift

Aluminum ferrules acc. to DIN 3093/ EN 13411-3 RX-lift

2.1

Veličina	A (mm)	B (mm)	S (mm)	L (mm)	Težina (g/kom)
Size					Weight
1	1.2	2.4	0.65	5	0,094
1.5	1.7	3.4	0.75	6	0,211
2	2.2	4.4	0.85	7	0,375
2.5	2.7	5.4	1.05	9	0,499
3	3.3	6.6	1.25	11	0,843
3.5	3.8	7.6	1.5	13	1,32
4	4.4	8.8	1.7	14	1,81
4.5	4.9	9.8	1.9	16	2,61
5	5.5	11.0	2.1	18	3,57
6	6.6	13.2	2.5	21	5,86
6.5	7.2	14.4	2.7	23	7,55
7	7.8	15.6	2.9	25	9,5
8	8.8	17.6	3.3	28	13,7
9	9.9	19.8	3.7	32	19,8
10	10.9	21.8	4.1	35	26,4
11	12.1	24.2	4.5	39	35,8
12	13.2	26.4	4.9	42	45,8
13	14.2	28.4	5.4	46	59,7
14	15.3	30.6	5.8	49	73,5
16	17.5	35.0	6.7	56	111
18	19.6	39.2	7.6	63	156

Veličina	A (mm)	B (mm)	S (mm)	L (mm)	Težina (g/kom)
Size					Weight
20	21.7	43.4	8.4	70	217
22	24.3	48.6	9.2	77	292
24	26.4	52.8	10.0	84	376
26	28.5	57.0	10.9	91	481
28	31.0	62.0	11.7	98	603
30	33.1	66.2	12.5	105	739
32	35.2	70.4	13.4	112	897
34	37.8	75.6	14.2	119	1077
36	39.8	79.6	15.0	126	1275
38	41.9	83.8	15.8	133	1503
40	44.0	88.0	16.6	140	1734
42	46.2	92.4	17.5	147	2024
44	48.4	96.8	18.3	154	2314
46	50.6	101.2	19.2	161	2662
48	52.8	105.6	20	168	3010
50	55.0	110.0	20.8	175	3412
52	57.2	114.4	21.6	182	3813
54	59.4	118.8	22.5	189	4293
56	61.6	123.2	23.3	196	4772
58	63.8	127.6	24.2	203	5326
60	66	132.0	25.0	210	5880

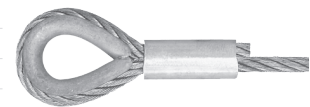
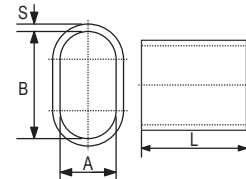

Bakrena klema RX-lift

Copper ferrules RX-lift

2.1

Za užje promjera (mm)	A (mm)	B (mm)	S (mm)	L (mm)
Rope dia.				
1	1.20	2.40	0.65	5
1.5	1.70	3.40	0.75	6
2	2.20	4.40	0.85	7
2.5	2.70	5.40	1.05	9
3	3.30	6.60	1.25	11
3.5	3.80	7.60	1.50	13
4	4.40	8.80	1.70	14
4.5	4.90	9.80	1.90	16
5	5.50	11.00	2.10	18
6	6.60	13.20	2.50	21
6.5	7.20	14.40	2.70	23
7	7.80	15.60	2.90	25
8	8.80	17.60	3.30	28
9	9.90	19.80	3.70	32
10	10.90	21.80	4.10	35
11	12.10	24.20	4.50	39

Za užje promjera (mm)	A (mm)	B (mm)	S (mm)	L (mm)
Rope dia.				
11	12.10	24.20	4.50	39
12	13.20	26.40	4.90	42
13	14.20	28.40	5.40	46
14	15.30	30.60	5.80	49
16	17.50	35.00	6.70	56
18	19.60	39.20	7.60	63
20	21.70	43.40	8.40	70
22	24.30	48.60	9.20	77
24	26.40	52.80	10.00	84

