

3. SPOJNI PRIBOR General hardware

3.1. Škopci

Škopac ravni sa maticom visokootporni G2150 RX-lift

High tensile steel dee shackle with safety pin G2150 RX-lift

2.1 2.2 CE MTCb BL

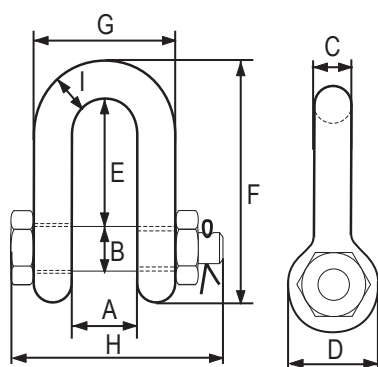

- Standard: EN 13889
- materijal: visokootporni čelik
- Faktor sigurnosti: 6:1
- Završna obrada: vruće galv.

Nosivost (t)	Oznaka	Veličina (in)	A (mm)	B (mm)	C (mm)	D (mm)	E (mm)	F (mm)	G (mm)	H (mm)	I (mm)	Težina (kg/kom)
WLL	Mark	Nom. size										Weight
0,5	1/2	1/4	11.9	7.85	6.35	15.5	19.1	40.4	24.6	39.6	6.35	0.06
0,75	3/4	5/16	13.5	9.65	7.85	19.1	25.4	48.5	29.5	46.2	7.85	0.10
1,0	1	3/8	16.8	11.2	9.65	23.1	31.0	58.5	35.8	55.0	9.65	0.15
1,5	1-1/2	7/16	19.1	12.7	11.2	26.9	36.1	67.5	41.1	63.5	11.2	0.22
2,0	2	1/2	20.6	16.0	12.7	30.2	41.4	77.0	46.0	71.0	12.7	0.34
3,25	3-1/4	5/8	26.9	19.1	16.0	38.1	51.0	95.5	58.5	89.5	16.0	0.67
4,75	4-3/4	3/4	31.8	22.4	19.1	46.0	60.5	115	70.0	103	20.6	1.14
6,5	6-1/2	7/8	36.6	25.4	22.4	53.0	71.5	135	81.0	120	24.6	1.74
8,5	8-1/2	1	42.9	28.7	25.4	60.5	81.0	151	93.5	135	25.4	2.52
9,5	9-1/2	1-1/8	46.0	31.8	28.7	68.5	91.0	172	103	150	31.8	3.45
12,0	12	1-1/4	51.5	35.1	31.8	76.0	100	191	115	165	35.1	4.90
13,5	13-1/2	1-3/8	57.0	38.1	35.1	84.0	111	210	127	183	38.1	6.24
17,0	17	1-1/2	60.5	41.4	38.1	92.0	122	230	137	196	41.1	8.39
25,0	25	1-3/4	73.0	51.0	44.5	106	146	279	162	230	54.0	14.2
35,0	35	2	82.5	57.0	51.0	122	172	312	184	264	51.0	21.2
55,0	55	2-1/2	105	70.0	66.5	145	203	377	238	344	66.5	38.6
85,0	85	3	127	82.5	76.0	165	216	429	279	419	89.0	56