

## 3. SPOJNI PRIBOR General hardware

### 3.1. Škopci

#### Škopac visokootporni omega G209 RX-lift

High tensile steel bow shackle G209 RX-lift

2.1 2.2 CE MTCb BL

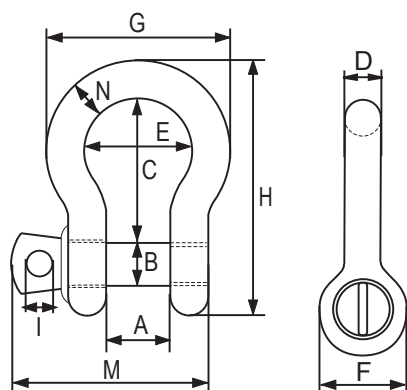

- Standard: EN 13889
- materijal: visokootporni čelik
- Faktor sigurnosti: 6:1
- Završna obrada: vruće galv.

Nosivost (t)	Oznaka	Veličina (in)	A (mm)	B (mm)	C (mm)	D (mm)	E (mm)	F (mm)	G (mm)	H (mm)	I (mm)	M (mm)	N (mm)	Težina (kg/kom)
WLL	Mark	Nom. size												Weight
0,33	1/3	3/16	9.65	6.35	22.4	4.85	15.2	14.2	24.9	37.3	4.06	28.4	4.85	0.03
0,5	1/2	1/4	11.9	7.85	28.7	6.35	19.8	15.5	32.5	46.7	4.85	35.1	6.35	0.05
0,75	3/4	5/16	13.5	9.65	31.0	7.85	21.3	19.1	37.3	53.0	5.60	42.2	7.85	0.09
1,0	1	3/8	16.8	11.2	36.6	9.65	26.2	23.1	45.2	63.0	6.35	51.5	9.65	0.14
1,5	1-1/2	7/16	19.1	12.7	42.9	11.2	29.5	26.9	51.5	74.0	7.85	60.5	11.2	0.17
2,0	2	1/2	20.6	16.0	47.8	12.7	33.3	30.2	58.5	83.5	9.65	68.5	12.7	0.33
3,25	3-1/4	5/8	26.9	19.1	60.5	16.0	42.9	38.1	74.5	106	11.2	85.0	17.5	0.62
4,75	4-3/4	3/4	31.8	22.4	71.5	19.1	51.0	46.0	89.0	126	12.7	101	20.6	1.07
6,5	6-1/2	7/8	36.6	25.4	84.0	22.4	58.0	53.0	102	148	12.7	114	24.6	1.64
8,5	8-1/2	1	42.9	28.7	95.5	25.4	68.5	60.5	119	167	14.2	129	26.9	2.28
9,5	9-1/2	1-1/8	46.0	31.8	108	29.5	74.0	68.5	131	190	16.0	142	31.8	3.36
12,0	12	1-1/4	51.5	35.1	119	32.8	92.5	76.0	146	210	17.5	156	35.1	4.31
13,5	13-1/2	1-3/8	57.0	38.1	133	36.1	92.0	84.0	162	233	19.1	174	38.1	6.14
17,0	17	1-1/2	60.5	41.4	146	39.1	98.5	92.0	175	254	20.6	187	41.1	7.80
25,0	25	1-3/4	73.0	51.0	178	46.7	127	106	225	313	25.4	231	57.0	12.6
35,0	35	2	82.5	57.0	197	53.0	146	122	253	348	31.0	263	61.0	20.4
42,5	42,5	2-1/4	95	65	220	57,0	160	143	274	32	33,0	321	66,0	32s
55,0	55	2-1/2	105	70.0	267	69.0	184	145	327	453	35.1	330	79.5	38.9