

## 2. PRIBOR G80 I G100 G80 and G100 accessories

### 2.1. Pribor G80

#### Spojnicna lanca VG G80 RX074

##### VG chain connecting link G80

2.1 2.2 CE BL

Promjer lanca (mm)	Nosivost (t)	Min. prekidna sila (t)	A (mm)	B (mm)	L (mm)	K (mm)	H (mm)	Težina (kg/ kom)
Chain dia.	WLL	MBL						Weight
6-8	1.12	4.48	15	7.5	58	42	7	0.08
7-8	1.5	6	20	8.5	73	54.8	8.5	0.145
7/8-8	2	8	20.5	9.5	79.5	60.5	8.5	0.146
8-8	2	8	20.5	9.5	79.5	60.5	8.5	0.16
10-8	3.15	12.6	26	12	90.5	68	11.5	0.30
13-8	5.3	21.2	30	15	117	87	15	0.65
16-8	8	32	35	19.8	148	108.4	19.8	1.15
18-8	10	40	38	21	154	112	21	1.84
20-8	12.5	50	41	24	169.5	121.5	24	2.1
22-8	15	60	49.5	26	193.5	141.5	26	2.87
26-8	21.2	84.8	57.5	31	220	158	30	4.5
32-8	31.5	126	67.5	38	281	205	37	8.21

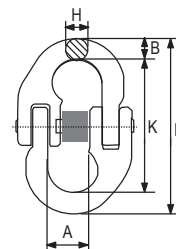

• EN 1677-1

#### Spojnicna lanca OMEGA G80 RX002

##### Omega chain connection link G80

2.1 2.2 CE BL

Promjer lanca (mm)	Nosivost (t)	Min. prekidna sila (t)	A (mm)	B (mm)	D (mm)	H (mm)	L (mm)	Težina (kg/ kom)
Chain dia.	WLL	MBL						Weight
6-8	1.12	4.48	8	41	20.5	25	52	0.12
7/8-8	2.0	8.0	10	52	23.5	35	68.5	0.22
10-8	3.15	12.6	12	62	31.5	40.5	81	0.36
13-8	5.3	21.2	15	81	41	54	108	0.71
16-8	8	32	19	99	49.5	64	126	1.3
18/20-8	12.5	50	23	118	58	75.6	152	2.2

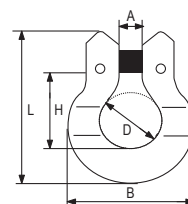

• EN 1677-1

#### Spojnicna poliesterske priveznice G80 RX001

##### Web sling connecting G80

2.1 2.2 CE BL

Nosivost (t)	Min. prekidna sila (t)	A (mm)	B (mm)	K (mm)	W (mm)	G (mm)	E (mm)	Težina (kg/ kom)
WLL	MBL							Weight
1.12	4.48	15	60	56	40	18	7	0.2
2.0	8.0	20	61.5	63.7	40	24	9.5	0.3
3.15	12.6	24	66	83	39	30.5	11	0.68
5.3	21.2	28	88	93.7	55	36.8	16.5	1.47
8	32	34.5	108	120	65.5	45.2	19.8	2.3
12.5	50	41	129	138	80	51.8	23	3.3

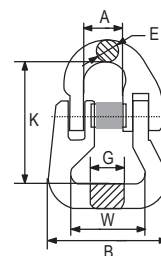

• EN 1677-1

#### Škopac G80 RX049

##### Dee shackle G80

2.1 2.2

Nosivost (t)	Min. prekidna sila (t)	A (mm)	B (mm)	D (mm)	L (mm)	Težina (kg/ kom)
WLL	MBL					Weight
2,0	8,0	15	32	9	56	0,14
3,15	12,6	21	43	11,5	71	0,27
5,3	21,2	25	51	14,5	91	0,5
8,0	32,0	30	63	17,5	111	0,89

