

2. PRIBOR G80 I G100 G80 and G100 accessories

2.1. Pribor G80

Skračivač-kuka za lanac dugi G80 RX142

Deep throat clevis shortening hook G80

2.1 2.2 CE BL

Promjer lanca (mm)	Nosivost (t)	Min. prekidna sila (t)	A (mm)	B (mm)	E (mm)	M (mm)	L (mm)	Težina (kg/kom)
Chain dia.	WLL	MBL						Weight
6-8	1.12	4.48	7.5	31.5	7.5	45	85	0.19
7/8-8	2	8	9	37.5	10	57	106	0.35
10-8	3.15	12.6	12.5	47.5	13	74	127	0.75
13-8	5.3	21.2	15	58.5	15.5	89	165.5	1.63

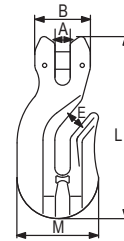

• EN 1677-1

Kuka klizna sa osiguračem G80 G80 RX072

Sliding eye choker hook G80

2.1 2.2 CE BL 

Nosivost (t)	Promjer č. užeta (mm)	A (mm)	B (mm)	C (mm)	D (mm)	E (mm)	F (mm)	G (mm)	Težina (kg/kom)
WLL	Rope dia.								Weight (kg)
0,8	6-11	112	63	19	65	14	30	16	0,4
1,6	10-13	143	82	26	83	17	30	19	0,8
2,5	14-16	170	98	30	97	19	33	25	1,2
3,2	16-20	196	115	36	110	22	40	28	1,9
5,4	22-26	260	142	46	145	36	60	35	4,3

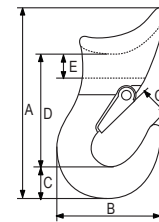

• EN 1677-1

Kuka za navarivanje G80 RX019

Weld on hook G80

2.1 2.2 CE BL

Nosivost (t)	Min. prekidna sila (t)	B (mm)	C (mm)	E (mm)	H (mm)	M (mm)	P (mm)	L (mm)	Težina (kg/kom)
WLL	MBL								Weight
1,0	5	77.6	61.3	25	93	23	25	101.6	0.49
2,0	10	92	67	28	81	23.4	34	114	0.87
3,0	15	106	73.5	30	116	30.5	36	129	1.13
5,0	25	133	94	39	159	44	43.5	171	2.5
8,0	40	137	94	36	159	44	51	177	3.26
10,0	50	170	135	48	194	54.7	53	223	5.2

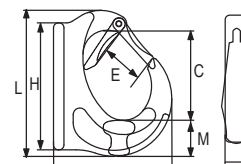

• EN 1677-1

Kuka otvorena G80 RX015

Eye foundry hook G80

2.1 2.2 CE BL

Nosivost (t)	A (mm)	D (mm)	P (mm)	K (mm)	H (mm)	T (mm)	Težina (kg/kom)
WLL							Weight
2,0	18	12	63,5	120	31	25	1,09
3,15	22	16	76	146	33	32	1,95
5,3	27	19	89	175	44,5	38	3,22
8,0	32	20	101	205	51,5	46	5,26
12,5	38	25	114	235	65	56	9,07
15,0	45	28,5	127	264	68,5	57	11,79

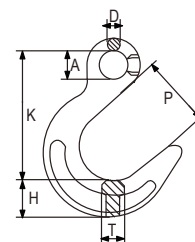

• EN 1677-1